

NOTES: UNLESS OTHERWISE SPECIFIED

1. SEE DRAWING NO. CB-00290 AND PROCEDURE P-1000 FOR ASSEMBLY AND TEST INSTRUCTION. PROCEDURES AND ASSEMBLY DRAWINGS ARE FOR INTERNAL USE ONLY.
2. ALL TESTING IS PERFORMED IAW BATTERY COUNCIL INTERNATIONAL STANDARDS.
3. DIMENSIONS ARE INCH [MILLIMETER].
4. TERMINAL HARDWARE KIT PROVIDED, PART NUMBER 6923.

REVISIONS			
REV	DESCRIPTION	DATE	APPROVED
G	REDESIGNED COVER	12/21/17	PH
H	REMOVED AGM-1285T FROM CAPACITY CHART	5/29/19	PH
J	STANDARDIZED ENVELOPE, ADDED NOTE 4	7/21/20	PH
K	REVISED CONTAINER	12/16/21	PH

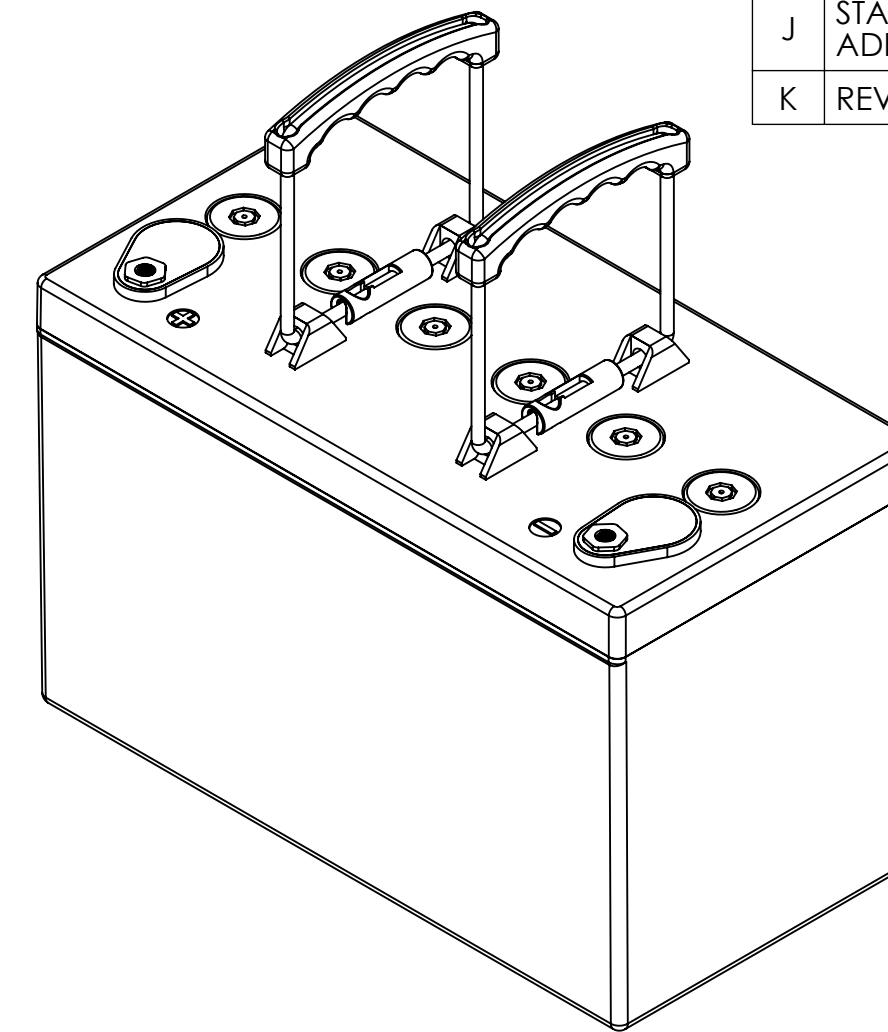
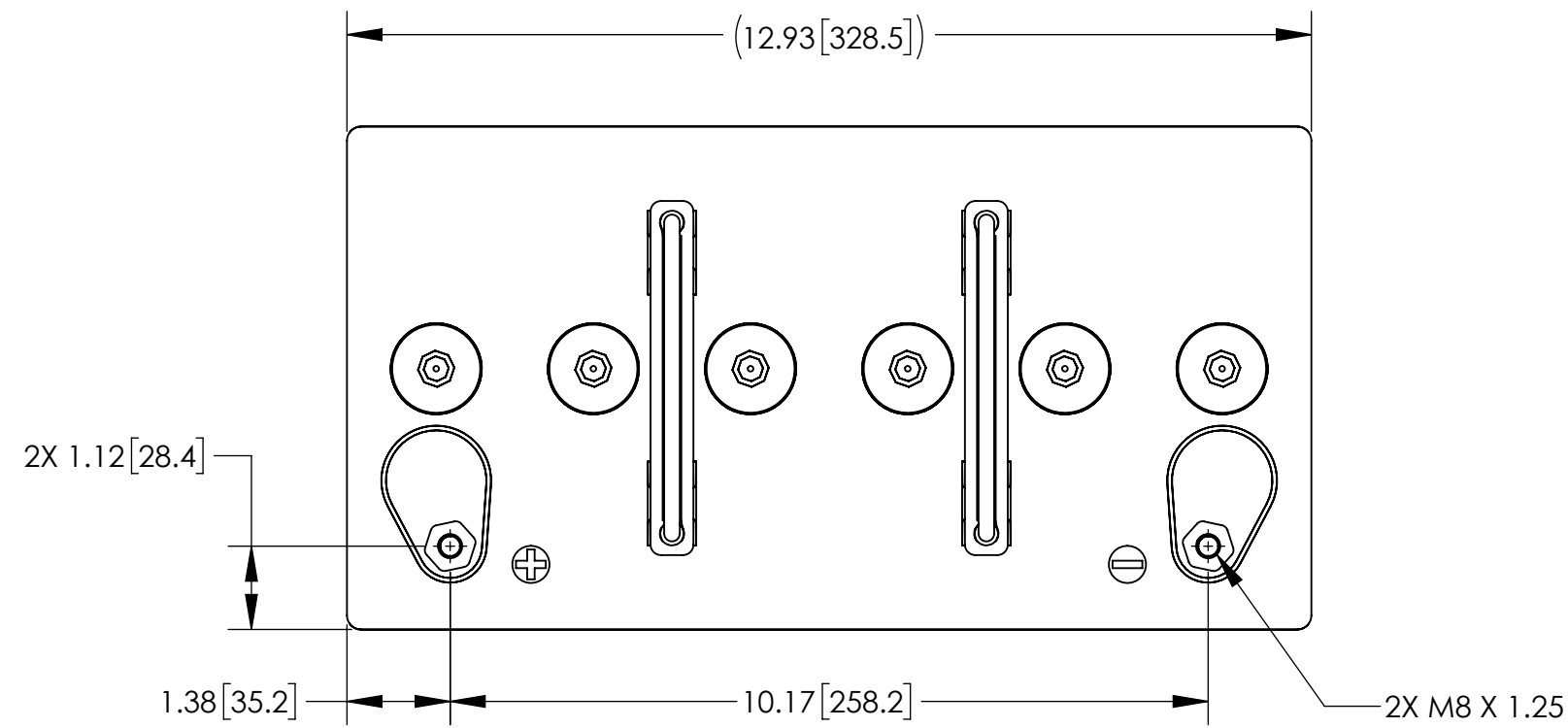

ISOMETRIC VIEW

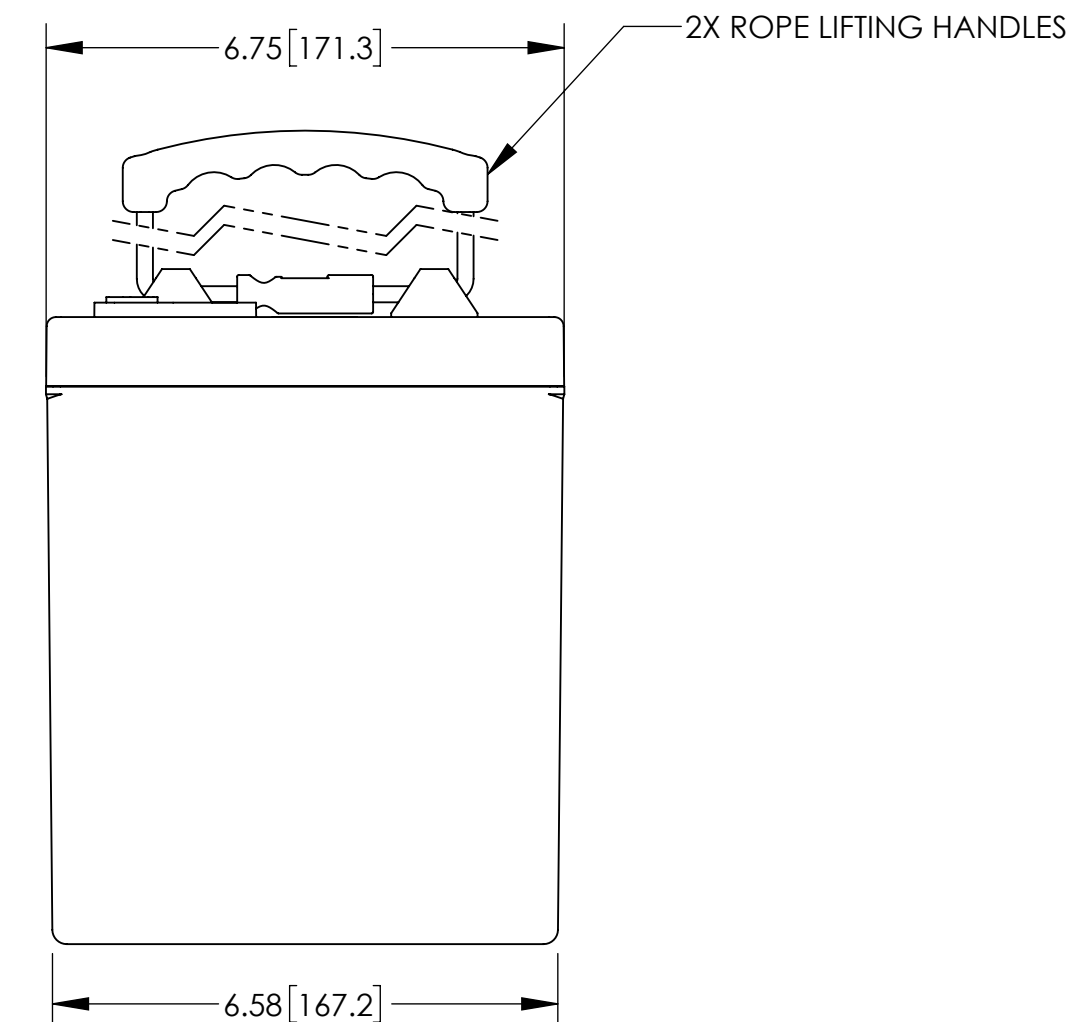
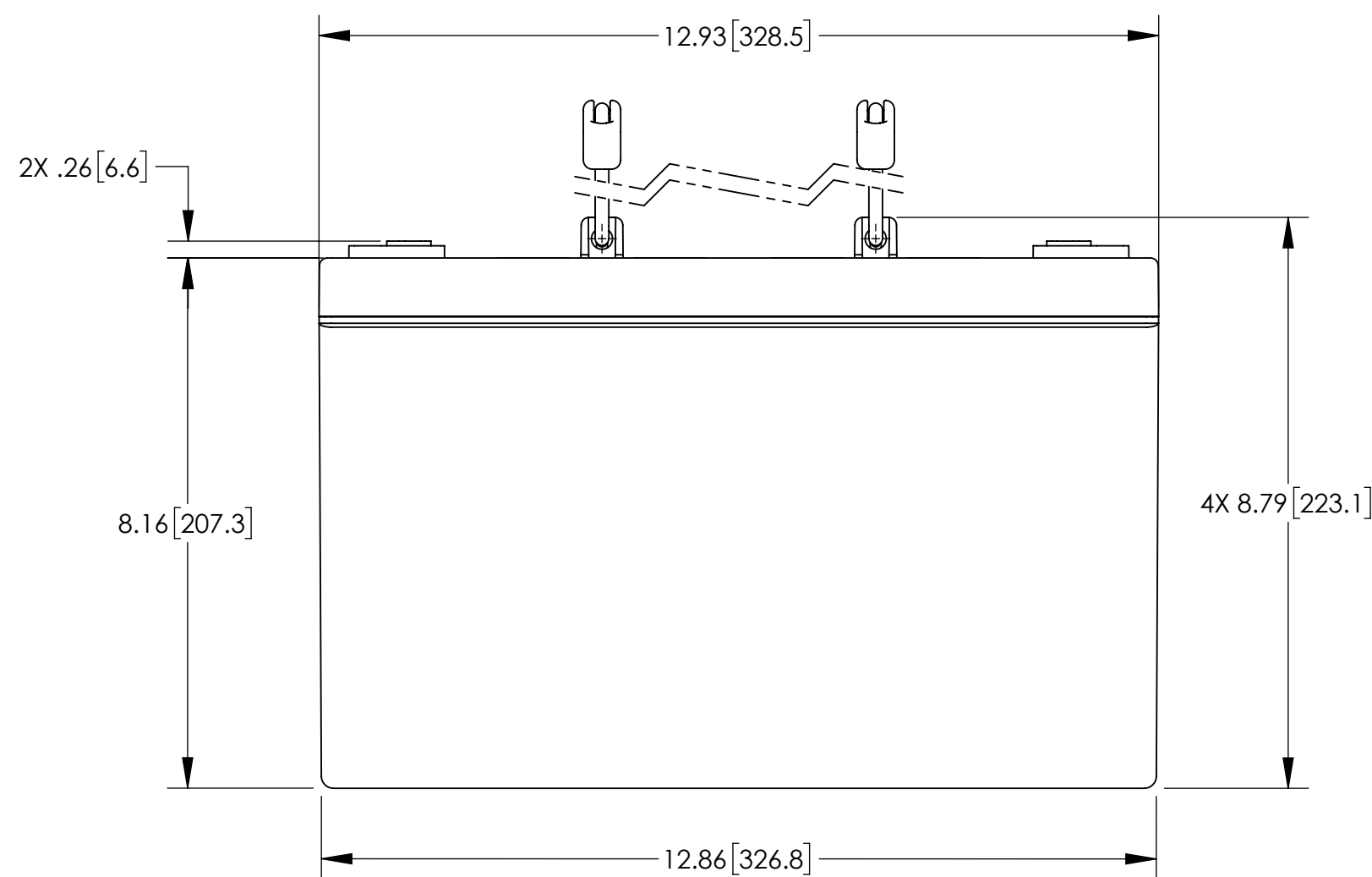

CAPACITY RATINGS	
PART NUMBER	AGM-12105T
NOMINAL WEIGHT	64 LBS [29 KG]
AMPERE HOUR CAPACITY @ 20 HOUR 1.75 VOLTS/CELL @ 77°F (25°C)	105 AH
MINUTES OF DISCHARGE @ 25 AMPS 1.75 VOLTS/CELL @ 77°F (25°C)	195 MIN

ENVELOPE DRAWING

UNLESS OTHERWISE SPECIFIED DIMENSIONS ARE IN INCHES TOLERANCES ARE:			CONTRACT NO.		CONCORDE BATTERY CORPORATION 2009 SAN BERNARDINO RD, W. COVINA, CA 91790			
FRACTIONS	DECIMALS	ANGLES	APPROVALS		DATE		TITLE	
±1/32	.XX ± .12 .XXX ± .060	±1°	DRAWN ELH		3/1/00		BATTERY, 12 VOLT, AGM-12105T	
TREATMENT	NONE		CHECKED S. VALDEZ		3/1/00		SIZE	REV
FINISH	NONE		APPROVED JBT		3/4/00		CAGE CODE	
SIMILAR TO	CALC WT		ISSUED DH		2/21/22		DWG NO.	
							AGM-12105T	K
			SCALE		1:2.5		SHEET 1 OF 1	